

# S2400P



Please use S2400 in its operating temperature range. Using S2400 outside of its optimal operating temperature range can push the machine beyond its safe limits. Do not submerge your S2400 in water. It is not waterproofed and this will void your warranty. Please keep S2400 upright and do not block the ventilation fan while using S2400.

## **What do you need to know about LMFP batteries?**

### **(LiMnxFe1-xPO4)**

LMFP batteries have an extremely long life and superior safety, capable of 2,000 cycles, 4-6 times longer than other lithium-ion batteries. Excellent thermal and chemical stability makes LMFP batteries safer than other lithium-ion batteries. In addition, LMFP batteries have a lower capacity loss than lithium-ion batteries, making them more suitable for use at high frequencies. It should be noted that when a LMFP battery is not used for a long time, it automatically enters a dormant state. In this state, the capacity of the battery is much lower than the actual capacity, so you may experience a rapid depletion of power when you first use the product after receiving it - this is not battery damage, but a normal condition that can occur with all LMFP batteries.

Please be assured that LMFP batteries are easily activated, and after just 3-5 normal charge and discharge cycles, the battery will be activated and returned to normal capacity. Therefore, if you experience a rapid depletion of power when using the product for the first time, please fully charge and try again. Because of this characteristic of LMFP batteries, we recommend that it is best to recharge the product every two months, even if you do not use it for a long time.



## Product front display

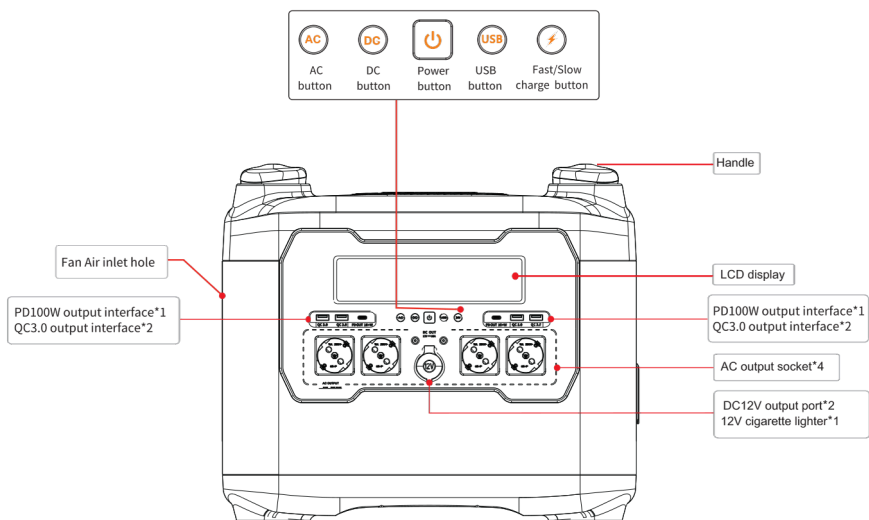

## Product right side display

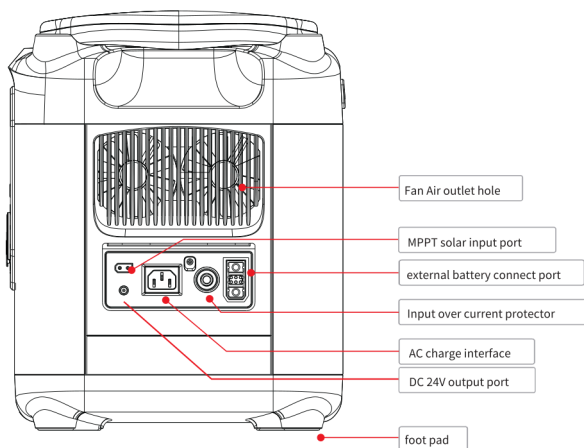

## Product back display

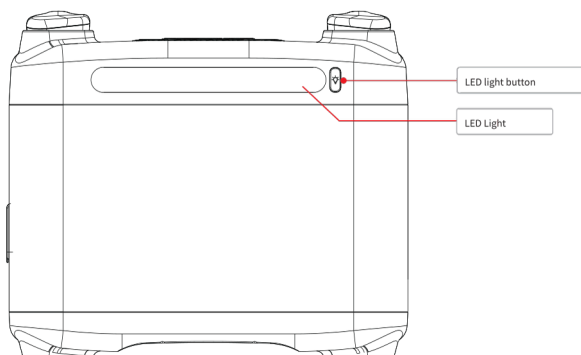

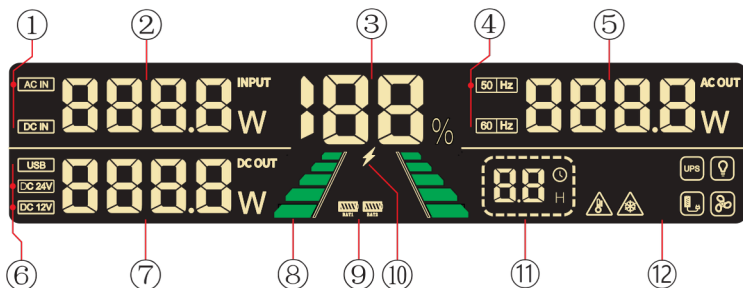

LED display instruction	
①	AC、DC input icon ,when the device is incharge ,the icon will light on .
②	Charging input power display ,When the device is charged by ac and dc together at the same time ,the charging power on the display is superimposed.
③	AC output frequency
④	power capacity
⑤	AC output power
⑥	USB,DC12V ,DC24V output icon ,when power on the buttons,the icons will light on
⑦	DC output power display : when USB,DC12V ,DC24V output at the same time ,the output power on the display is superimposed .
⑧	5 LEVEL Battery display
⑨	External battery icon : when the icon is light on ,it means the external battery is connecting with the main device
⑩	super charge icon : when the icon is light on ,it means the device in super charge mode . If this icon is go out ,it means the device in normal charge mode .
⑪	Remaining usage time
⑫	UPS icon : when open up the UPS function ,the icon will light on
	LED light icon : when turned on the led light ,the icon will light on
	High temperature warn icon ,when the working temperature is reaching the preload highest temperature level , the icon will light on .
	Low temperature warn icon ,when the working temperature is reaching the preload lowest temperature level ,the icon will light on .
	External battery connection icon , when the external battery is connecting with the main device ,the icon will light on .
	Fan icon ,when the fans start work ,the icon will light on .

## Using your product

### 1, Power button

1.1 Short press the “Power Button” to turn the machine on.

1.2 When product is turned on, short press the “Power Button” to turn off the led display.

1.3 After using, long press the “Power Button” for 2 secs to shut down.

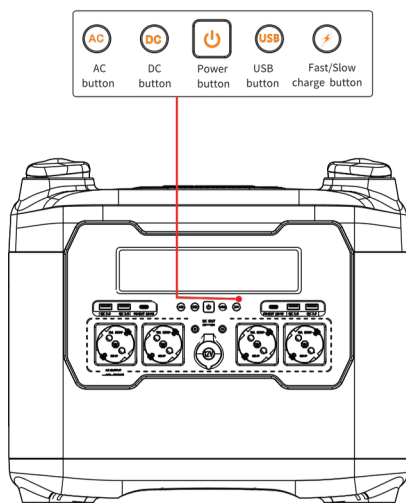

## DC outputs function

### 1. Type -C output port

First, short press the "Power Button" to turn the machine on.  
Second, short press on "USB output button".

### 2. USB -output port

After turning on the machine, short press the "USB button" to turn on the USB output function.

### 3. DC output and cigarette lighter

After turning on the machine, short press the "DC button" to turn on the DC output function.

When the USB, DC12V, DC24V output ports are working at the same time, the output power on the display is superimposed.

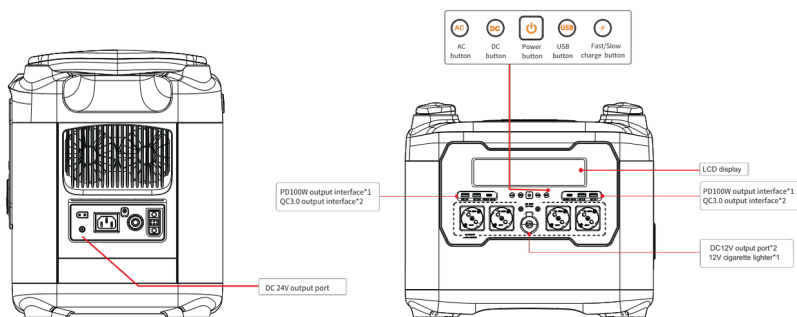

## How do you charge your machine?

### 1. Via wall outlet

At home, please use original cable to charge via Wall outlet. The max AC charge power is 220V/2000W or 110V/1500W. When in charging, the super charge icon will light on (the Max ac input power is 220V/2000W or 110V/1500W, when the power is low or the battery is almost full, or in abnormal environment temperature, the input power will turn down. All those reactions are normal. When charge via Wall outlet, long press the "Fast/slow charge switch button" for 3 seconds, it will turn to normally charge, the input power will turn to 500W.

**Please use original charging cable and keep sure the wall socket power is more than 10A. If the wall AC socket is burnt or deformed, please do not use it .**

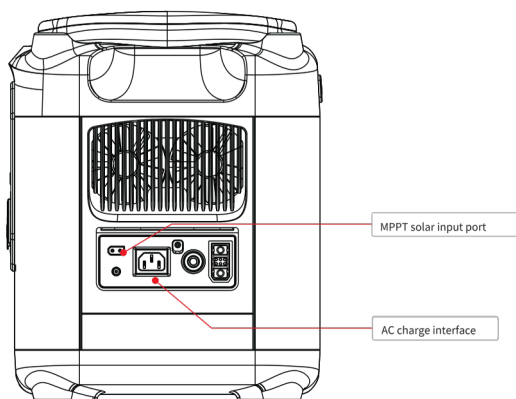



## AC outputs function

### Can S2400 power my devices while it's charging?

Yes, S2400 can be charging and outputting power in the same time. When you are charging S2400, we do not recommend connecting an electrical appliance with a power over 2400w for discharging, because the current capacity of the wall outlet is limited.

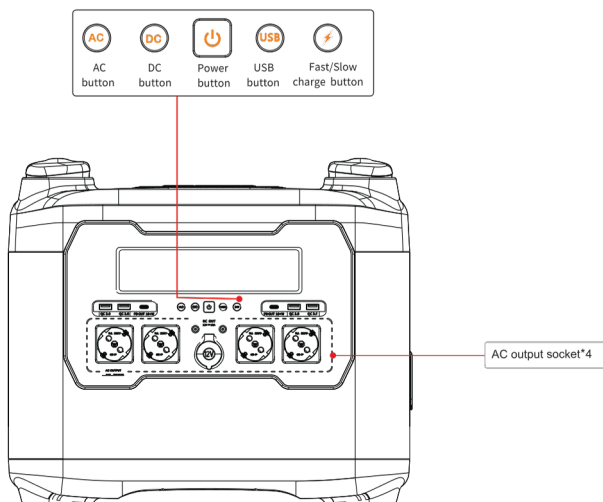

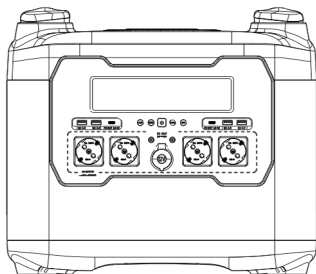

Model	S2400P
Battery capacity	<b>2047.5Wh ,48.75V 42Ah</b>
DC output	<b>24V <math>\approx</math>5A(Max180W)</b>
DC output	<b>12V <math>\approx</math>10A(Max180W)</b>
Cigarette lighter output	<b>12V <math>\approx</math>10A(Max180W)</b>
USB output	QC3.0*4 5v 3A ,9V 2A,12V 1.5A
Type-C output	5V, 9V, 12V, 15V $\approx$ 3A/20V $\approx$ 5A (PD100W)
Mppt input	<b>12-100V 1200w</b>
AC output	<b>110V50Hz/60Hz or 230V50Hz 2400W</b>
AC input	<b>2000W</b>
Working temperature	<b>-20—60°C</b>
UPS	<b>20Ms</b>

## Fault code

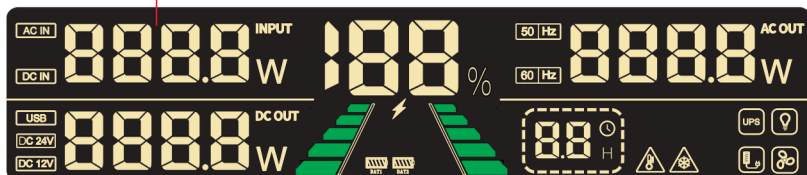

- Fault Code: E01

Fault Content: DC output overload

Fault Solution: Disconnect the devices in the DC connection, short press the DC button to switch on the DC output function.

- Fault Code: E02

Fault Content: DC output short-circuit

Fault Solution: Disconnect the devices in the DC connection, short press the DC button to switch on the DC output function.

- Fault Code: E03

Fault Content: AC output/input overload or short-circuit

Fault Solution: Disconnect the AC output device, short press the AC button to switch on the AC function.

- Fault Code: E04

Fault Content: AC output over-temperature

Fault Solution: Disconnect the device in the AC connection. When the working temperature returns to the normal level, the fault code will be removed.

- Fault Code: E05

Fault Content: AC output undervoltage

## **Fault code**

- Fault Code: E06

Fault Content: AC output overvoltage

- Fault Code: E07

Fault Content: PD output overload or short-circuit

Fault Solution: Disconnect the devices in the PD connection and briefly press the USB button.

- Fault Code: E08

Fault Content: USB-A output overload or short-circuit

Fault Solution: Disconnect the devices in USB-A connection first. Short press the USB button.

- Fault Code: E09

Fault Content: DC charging over-voltage

Fault Solution: Disconnect the device in DC connection. Once the voltage turns to normal, the fault condition will be removed automatically.

- Fault Code: E10

Fault Content: DC charging low-voltage

Fault Solution: Disconnect the device in DC connection. Once the voltage turns to normal, the fault condition will be removed automatically.

## **Fault code**

- Fault Code: E11

Fault Content: AC input low voltage

Fault Solution: After the AC input voltage is restored to the normal voltage range, re-insert the charging port.

- Fault Code: E12

Fault Content: AC input high voltage

Fault Solution: After the AC input voltage is restored to the normal voltage range, re-insert the charging port.

- Fault Code: E13

Fault Content: Battery over-temperature

Fault Solution: Disconnect all the devices. When the working temperature returns to the normal level, the fault code will be removed.

- Fault Code: E14

Fault Content: Battery low-temperature

Fault Solution: Disconnect all the devices. When the working temperature returns to the normal level, the fault code will be removed.

- Fault Code: E15

Fault Content: Battery over temperature during charging/discharging

Fault Solution: Disconnect all the devices. When the working temperature returns to the normal level, the fault code will be removed.

- Fault Code: E183

Fault Content: Expansion pack battery connection failure

Fault Solution: Turn off the product, unplug and plug the expansion pack battery connection cable again then restart